

# WESTMOUNT VILLAGE

213-A Overmount Avenue, Woodland Park, NJ 07424 (973) 947-7681



The Borough of Woodland Park in Passaic County is home to Westmount Village, a charming collection of 894 rental apartments. Each one and two bedroom apartment home features spacious interiors with air conditioning and a balcony or patio (per plan). Residents relish in the many conveniences that are available including the onsite laundry facilities and easy access to major local highways 3, 46, 80 and the Garden State Parkway. The area's top-rated school system is an asset to those with school-aged children.

[www.WestmountVillageNJ.com](http://www.WestmountVillageNJ.com) (973) 947-7681



WE ARE AN EQUAL HOUSING OPPORTUNITY PROVIDER. WE DO NOT DISCRIMINATE ON THE BASIS OF RACE, COLOR, SEX, NATIONAL ORIGIN, RELIGION, HANDICAP OR FAMILIAL STATUS.

WF-Westmount010417



# Westmount Village

Bedrooms	Plan	Baths	Area	Pricing
1	One Bedroom	1	720 sq. ft.	\$1350 - \$1450
2	Two Bedroom	1	1105 sq. ft.	\$1675 - \$1700

Rent includes: Heat and Hot Water \*All prices are subject to change.

## Apartment Amenities

- Air Conditioning
- Hardwood Floors
- Eat-In Kitchen
- Private Patio or Balcony
- Garages Available

## Community Amenities

- 24-hour Emergency Maintenance
- Security Lighting
- Cable Ready
- Swimming Pool
- Laundry Facilities
- Verizon FIOS Available

## Appliances

- Dishwasher
- Refrigerator/Freezer
- Oven/Range
- Range Hood

Visit our website - [www.WestmountVillageNJ.com](http://www.WestmountVillageNJ.com)

## Rental Office Hours

Monday	Tuesday	Wednesday	Thursday	Friday	Saturday	Sunday
8-4	8-4	8-4	8-4	8-4	9-2	closed

When you decide to join us, please provide us the following at time of application:

- Two Personal Checks or Money Orders. We do not accept cash:
  1. Non-refundable Application processing Fee payable to GARDEN HOMES. \$50 for 1st Applicant; \$25 for each additional Applicant.
  2. \$200 check payable to ROSE MANOR ESTATES, INC. To be applied to your Security Deposit upon approval; or refunded if your application is declined.
- Two Current Pay Stubs
- Valid Photo ID
- Social Security Card

We are an equal opportunity provider. We do not discriminate on the basis of race, color, sex, national origin, religion, handicap or familial status.

# Westmount Village

## One Bedroom Floor Plan with 1 Bath, 720 sq. ft.

Standard

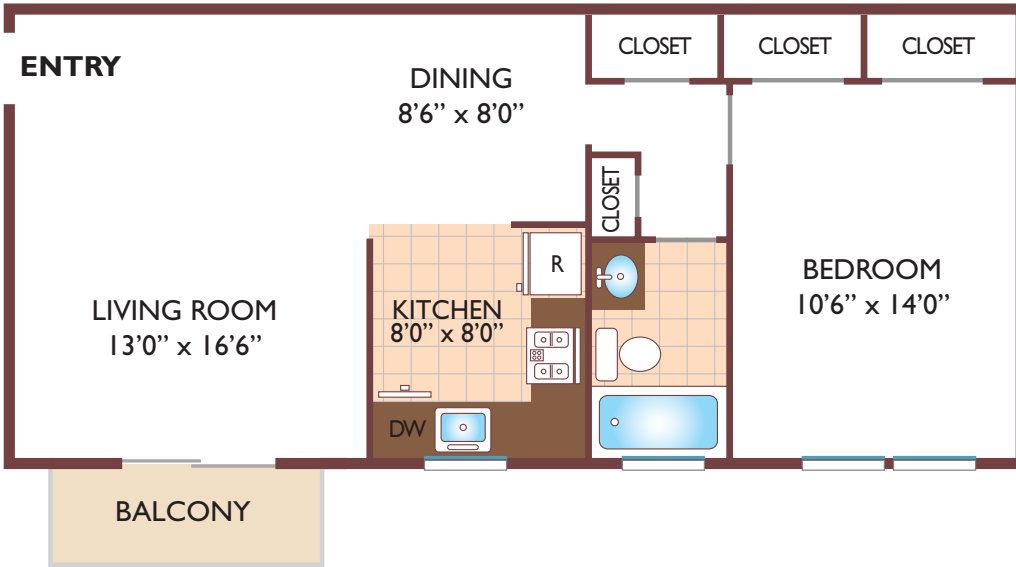

## Two Bedroom Floor Plan with 1 Bath, 1105 sq. ft.

Standard



All dimensions, positions, locations and details are approximate.  
All rent prices and community information subject to change.

