

# LAMBERTS MILL VILLAGE

333 Spruce Mill Lane, Scotch Plains, NJ 07076 (908) 543-4543



Lamberts Mill Village is a collection of 332 apartment residences rising in the Union County township of Scotch Plains. Units are available with one, two or three bedrooms and range in size from 935 to 1,685 square feet. Each spacious home boasts a number of sought after appointments including kitchens with refrigerators and ovens, carpeting and hardwood flooring, central air, washer and dryer and patio or balcony (per plan). Select apartments are available that feature a new kitchen with Granite counter- tops & ceramic tile flooring, ceramic tile entry, new bathroom, and two tone decorator paint colors. Residents also enjoy the convenience of having an onsite swimming pool.

[www.LambertsMillVillageNJ.com](http://www.LambertsMillVillageNJ.com) (908) 543-4543



WE ARE AN EQUAL HOUSING OPPORTUNITY PROVIDER. WE DO NOT DISCRIMINATE ON THE BASIS OF RACE, COLOR, SEX, NATIONAL ORIGIN, RELIGION, HANDICAP OR FAMILIAL STATUS.

WF-LambertMill05052020



# Lamberts Mill Village

Bedrooms	Name	Baths	Area	Pricing
1	1 Bedroom	1	935-1,675 sq. ft.	\$2,400 - \$2,495
2	2 Bedroom Townhome	1.5	1,100-1,540 sq. ft.	\$3,305
3	3 Bedroom Townhome	2.5	1,685-2,390 sq. ft.	\$3,175 - \$3,440

\*All prices are subject to change.

## Apartment Amenities

- Cable-Ready
- Large Dining Area
- Resident Controlled Central Air & Heat
- Finished Basements (select models)
- Newly Renovated Interiors (select apartments)
- Spacious Floor Plans
- Hardwood Flooring
- Private Patio or Balcony

## Community Amenities

- 24-Hour Emergency Maintenance
- Natural Gas
- Security Lighting
- Tennis Court(s)
- Cable Ready
- Pickle Ball Court
- Smoke-Free Community
- Top Rated Scotch Plains Public School System
- Easy Access To NYC Transportation
- Playground
- Swimming Pool
- Verizon FIOS Available

## Appliances

- Dishwasher
- Range Hood
- Microwave ( Select Apartments)
- Refrigerator/Freezer
- Oven/Range
- Washer & Dryer in Apartment

**Visit our Website - [www.LambertsMillVillageNJ.com](http://www.LambertsMillVillageNJ.com)**

## Rental Office Hours

Monday 10-5	Tuesday 10-5	Wednesday 10-5	Thursday 10-5	Friday 10-5	Saturday 10-5	Sunday 10-5
----------------	-----------------	-------------------	------------------	----------------	------------------	----------------

When you decide to rent with Garden Communities, the following items will be required when you submit your application:

- Non-refundable online application processing Fee. \$85 per applicant
- An online deposit of \$200 in order to reserve an apartment. This amount will be applied to your first month's rent upon approval and ONLY refunded if your application is declined.
- A valid photo ID and social security card.

We are an equal opportunity provider. We do not discriminate on the basis of race, color, sex, national origin, religion, handicap or familial status.

# Lamberts Mill Village

Scotch Plains, NJ

One Bedroom

1 Bed, 1 Bath | 935 SF

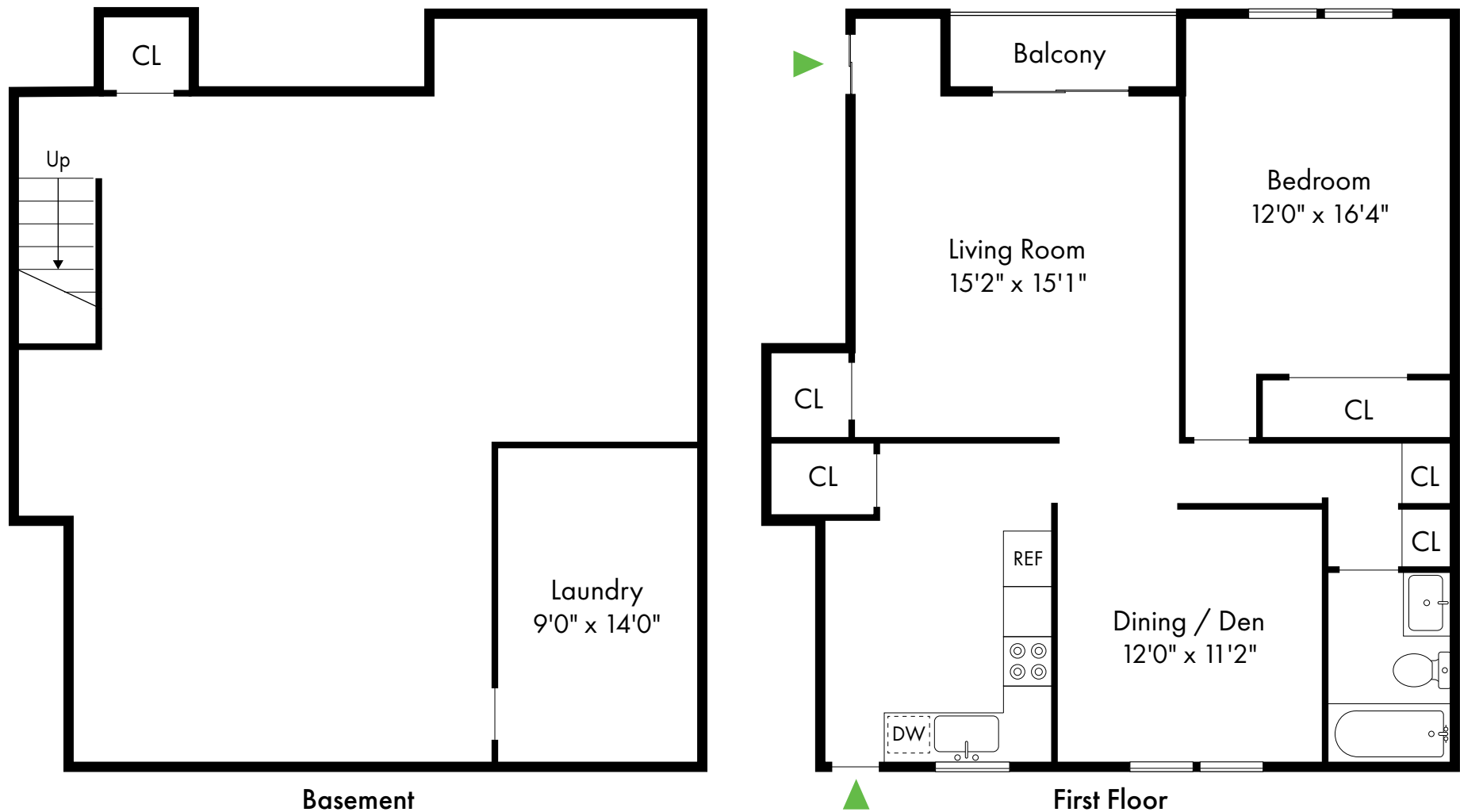

# Lamberts Mill Village

Scotch Plains, NJ

Two Bedroom Townhome

2 Bed, 1.5 Bath | 2,050 SF



# Lamberts Mill Village

Scotch Plains, NJ

Three Bedroom Townhome

3 Bed, 2.5 Bath | 1,685 - 2,390 SF

