

# WESTMOUNT VILLAGE

## LEASING OFFICE

973.947.7681

WestmountVillageNJ.com

213-A Overmount Avenue  
Woodland Park, NJ 07424



# WESTMOUNT VILLAGE

## SPACIOUS HOMES | CONVENIENT LOCATION

Nestled in the Passaic County town of Woodland Park, Westmount Village is a charming rental community of 894 apartments. Each one- and two-bedroom residence offers spacious interiors, air conditioning, and either a private balcony or patio. Residents can take advantage of the swimming pool and many of the community's conveniences, including the onsite laundry facilities and easy access to major local highways 3, 46, 80, and the Garden State Parkway. The area's top-rated school system is an asset to those with school-aged children.

**Westmount Village offers a stunning selection of spacious one- and two-bedroom rental residences. Find the perfect floor plan to fit your lifestyle.**



All renderings, amenities, existing or future views and photos depicted or otherwise described herein are proposed and conceptual only, and are based upon preliminary development plans, which are subject to withdrawal, revisions, and other changes, without notice. Please inquire within for more details.

2.13.24



# TESTmount Village

Bedrooms	Name	Baths	Area	Pricing
1	One Bedroom	1	720-1,105 sq. ft.	\$1,950 - \$2,175
2	Two Bedroom	1	1,105 sq. ft.	\$2,620 - \$2,810

\*All prices are subject to change.

## Apartment Amenities

- Air Conditioning
- Private Patio or Balcony
- Eat-In Kitchen
- Garages Available

## Community Amenities

- 24-Hour Emergency Maintenance
- Security Lighting
- Cable Ready
- Swimming Pool
- Laundry Facilities
- Verizon FIOS Available

## Appliances

- Dishwasher
- Refrigerator/Freezer
- Oven/Range
- Range Hood

**Visit our Website - [www.WestmountVillageNJ.com](http://www.WestmountVillageNJ.com)**

## Rental Office Hours

Monday 8-4	Tuesday 8-4	Wednesday 8-4	Thursday 8-4	Friday 8-4	Saturday 9-3	Sunday 9-3
---------------	----------------	------------------	-----------------	---------------	-----------------	---------------

When you decide to rent with Garden Communities, the following items will be required when you submit your application:

- Non-refundable online application processing Fee. \$85 per applicant
- An online deposit of \$200 in order to reserve an apartment. This amount will be applied to your first month's rent upon approval and ONLY refunded if your application is declined.
- A valid photo ID and social security card.

We are an equal opportunity provider. We do not discriminate on the basis of race, color, sex, national origin, religion, handicap or familial status.



# Westmount Village

## One Bedroom Floor Plan with 1 Bath, 720 sq. ft.

Standard

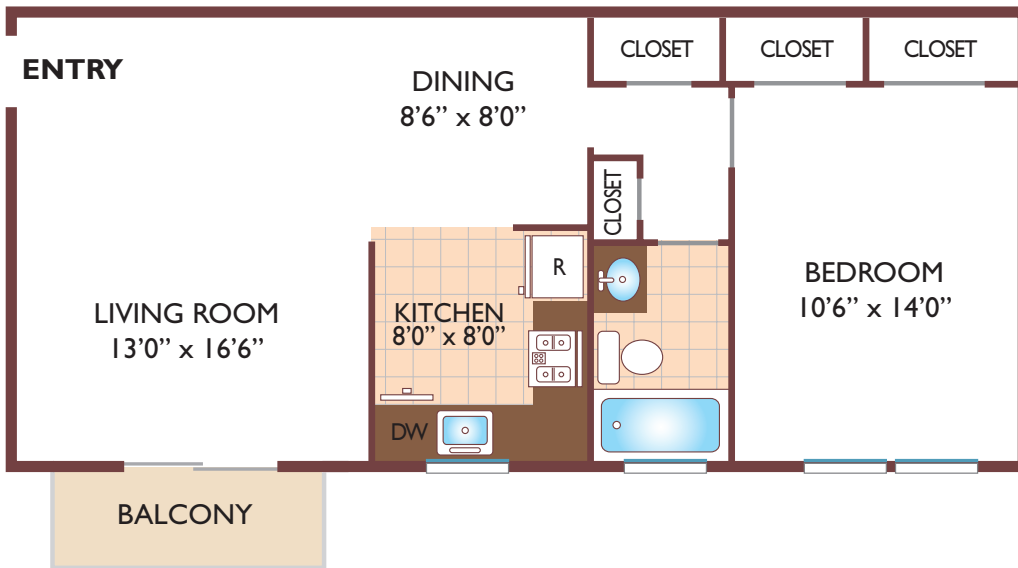

## Two Bedroom Floor Plan with 1 Bath, 1105 sq. ft.

Standard



All dimensions, positions, locations and details are approximate.  
All rent prices and community information subject to change.

