

WOODCREST AT BERKELEY HEIGHTS 55+

LEASING OFFICE

908.498.7239

WoodcrestAtBerkeleyHeightsNJ.com

100 Locust Avenue
Berkeley Heights, NJ 07922



WOODCREST AT BERKELEY HEIGHTS-55+

SPACIOUS HOMES | UPSCALE AMENITIES | CONVENIENT LOCATION

Welcome to Woodcrest at Berkeley Heights, a luxury 55+ rental apartment community in picturesque Berkeley Heights, NJ. Our spacious 1- and 2-bedroom layouts ranging from 942 to 1,731 square feet boast top-tier features like stylish breakfast bars, quartz countertops, stainless steel appliances, private balconies or patios, 9' high ceilings, wood plank flooring, carpeted bedrooms, double sinks in the primary suite, generous closets, in-suite washers and dryers, and resident-controlled air and heat. Our top-tier amenities include a modern fitness center, a cozy clubhouse with social events, 24-hour emergency maintenance, covered parking, and a smoke-free, pet-friendly environment near public transportation. Enjoy the plethora of nearby Union County parks, shopping, restaurants, and attractions. Discover luxury, convenience, and community at Woodcrest at Berkeley Heights—your ideal home awaits.

Woodcrest at Berkeley Heights offers a stunning selection of spacious one- and two-bedroom rental residences. Find the perfect floor plan to fit your lifestyle.



All renderings, amenities, existing or future views and photos depicted or otherwise described herein are proposed and conceptual only, and are based upon preliminary development plans, which are subject to withdrawal, revisions, and other changes, without notice. Please inquire within for more details.

7.24.24

Woodcrest at Berkeley Heights - 55+

Bedrooms	Name	Baths	Area	Pricing
1	1A	1	942 sq. ft.	\$3,200
1	1D	1	1,434 sq. ft.	\$3,450
1	1D.2	2	1,547 sq. ft.	\$3,650
2	2A	2	1,386 sq. ft.	\$3,600
2	2C	2	1,513 sq. ft.	\$4,200
2	2B	2	1,731 sq. ft.	\$4,300

*All prices are subject to change.

Apartment Amenities

- Carpeted Bedrooms
- Primary Suite with Double Sink
- Voluminous 9' High Ceilings
- Generous Closet Space
- Quartz Kitchen Countertops
- Wood Plank Flooring
- Living Room with Private Balcony/Patio
- Resident Controlled Central Air & Heat

Community Amenities

- 24-Hour Emergency Maintenance
- Covered Parking
- Public Transportation
- Cable Ready
- Elevator
- Smoke-Free Community
- Clubhouse
- Fitness Center
- Verizon FIOS Available

Appliances

- Dishwasher
- Refrigerator/Freezer
- Microwave
- Oven/Range

Visit our Website - www.WoodcrestAtBerkeleyHeightsNJ.com

Rental Office Hours

Monday	Tuesday	Wednesday	Thursday	Friday	Saturday	Sunday
8:30 - 4:30	8:30 - 4:30	8:30 - 4:30	8:30 - 4:30	8:30 - 4:30		

When you decide to rent with Garden Communities, the following items will be required when you submit your application:

- Non-refundable online application processing Fee. \$85 per applicant
- An online deposit of \$500 in order to reserve an apartment. This amount will be applied to your first month's rent upon approval and ONLY refunded if your application is declined.
- A valid photo ID and social security card

We are an equal opportunity provider. We do not discriminate on the basis of race, color, sex, national origin, religion, handicap or familial status.

Woodcrest at Berkeley Heights

55+ Active Adult Community

One Bedroom Floor Plan

Unit 1A

1 Bath, 942 sq. ft.



One Bedroom w/Den Floor Plan

Unit 1D

1 Bath, 1434 sq. ft.

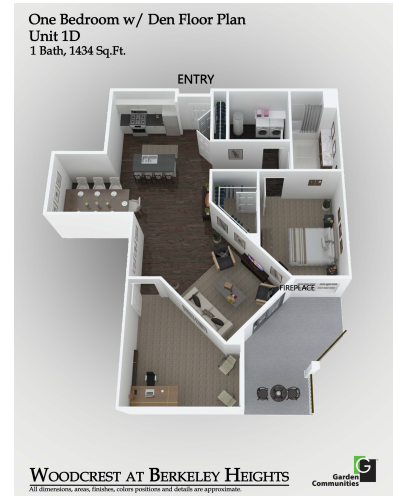

Two Bedroom Floor Plan

Unit 2A

2 Bath, 1386 sq. ft.



Two Bedroom w/Den Floor Plan

Unit 2B

2 Bath, 1731 sq. ft.



All dimensions, positions, locations and details are approximate
All rent prices and community information are subject to change

100 Locust Avenue, Berkeley Heights NJ 07922
P: (908) 498 - 7239



www.WoodcrestAtBerkeleyHeightsNJ.com
WoodcrestAtBerkeleyHeight.Rental@GardenCommunities.com